

## WORKSTATIONS

### RTW TABLE

Item Numbers 3000-3115



RTW Table with optional accessories.

#### Assembly Tips

- Review entire instruction manual before proceeding.
- Production Basics nameplate indicates front of frame.
- Legs are adjustable in 2-inch increments between 30-36 inches high to customize worksurface height.
- Don't be a slave to gravity-recruit a co-worker to help you install and correctly position components and accessories.
- References to 'Left' and 'Right' are oriented as if you were facing the front of the workstation.
- Need help? Call Assembly Support at 800.318.2770.

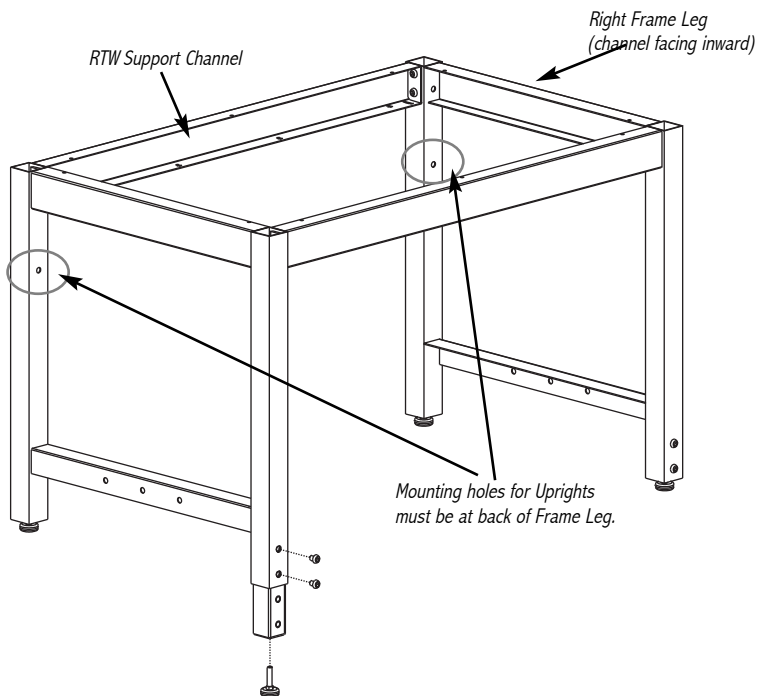

PARTS AND HARDWARE	QUANTITY
Frame Legs (left and right specific)	2
Leg Adjusters	4
RTW Support Channel	2
Chrome Mounting Plate	4
Worksurface	1
Leveling Feet	4
End Caps	6
Wood Screws	12
Basic Bolts	16
Allen Wrench	1

#### Other Items Needed (not included)

Phillips head drill or screwdriver

Rubber mallet

Level

Tape Measure

To view an expanded hardware kit, download this linked PDF.

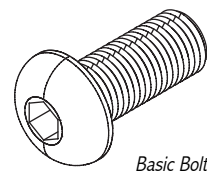

Basic Bolt

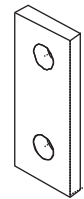

Chrome Mounting Plate

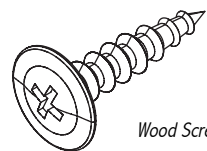

Wood Screw

1. Open the cartons and identify the left and right Frame Legs and RTW Support Channels. Position Frame Legs so that pre-drilled holes are at the back of the RTW Table. Frame Legs have a horizontal open channel that faces inward.
2. Screw the levelling feet all the way into the leg adjusters.
3. Slide leg adjusters into bottom of Frame Legs. Determine desired table height and secure position by inserting two (2) Basic Bolts. Adjust leveling feet if necessary.

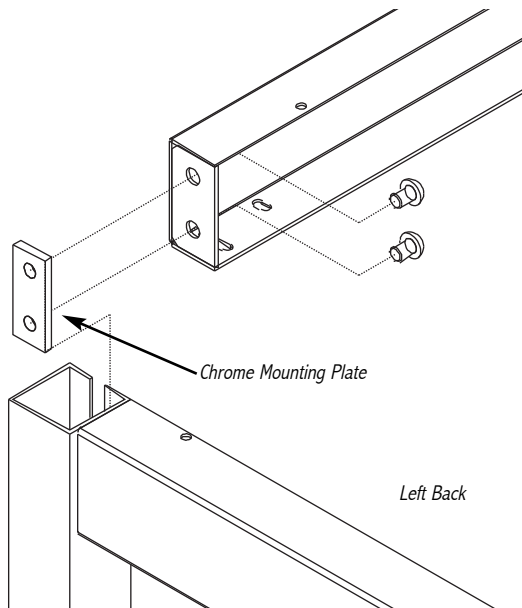

4. Locate Support Channel. Loosely attach the Chrome Mounting Plate to the outside of the Support Channel with two (2) Basic Bolts using Allen wrench provided.
5. Slip the Chrome Mounting Plate into the slot on the frame leg as shown. The leg will be between the Chrome Mounting Plate and the Support Channel. Repeat for all sides and tighten bolts.
6. Position the worksurface on the frame so that it is flush with the back of unit with equal overhang, left and right. It is often easier to invert the assembled RTW frame onto the underside of the worksurface for proper positioning.
7. Attach the worksurface to the frame by drilling wood screws through the pre-drilled holes in the Support Channels and Frame Legs, then into underside of worksurface. Turn RTW Table right side up.

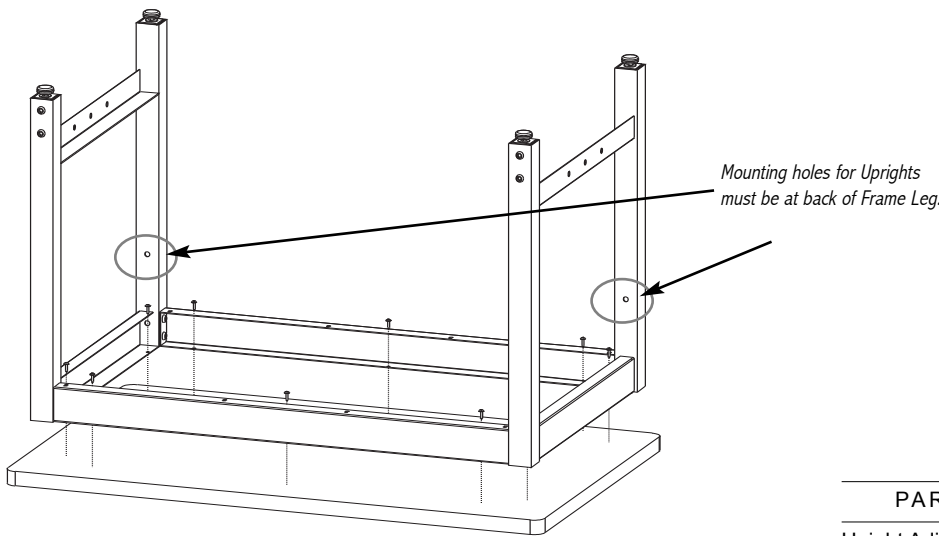

## RTW ADD-ON CORNER

Item Numbers 3418-3519

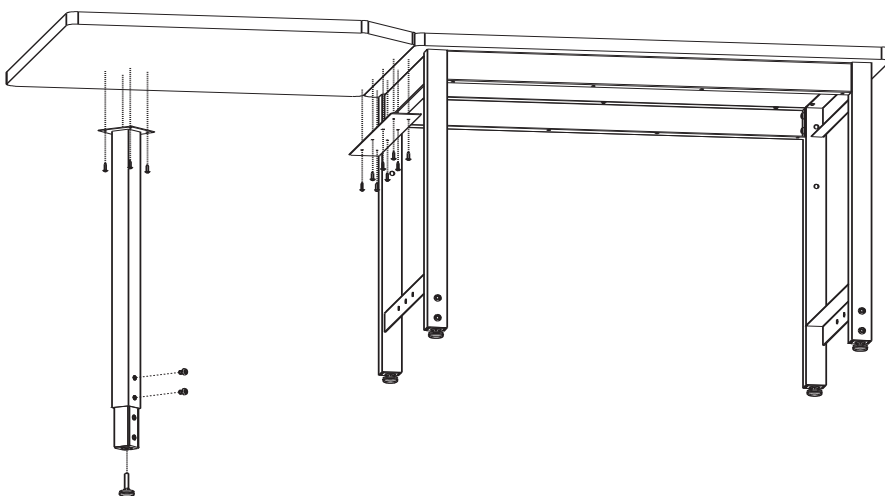

PARTS AND HARDWARE	QUANTITY
Height Adjustable Leg (2 pieces each)	1
Leveling Foot	1
Connection Plates	2
Laminate Worksurface	1
Basic Bolts	2
Wood screws	20
Allen Wrench	1
<b>Other Items Needed (not included)</b>	
Phillips head drill or screwdriver	

▪ **Note: Add-on Corner requires two (2) RTW Tables for proper assembly. Assemble RTW Tables before assembling Add-on Corner.**

1. Set height of adjustable leg and screw in leveling foot.
2. Insert three (3) wood screws through connection plate and into the underside of the worksurface. Repeat for other connection bracket on opposite RTW Table.
3. Place the corner in between the workstations. Secure with wood screws.
4. Use wood screws to attach adjustable leg to underside of worksurface 1" from edge.

# GROUND BOLT

For ESD Laminate Worksurfaces and Shelving

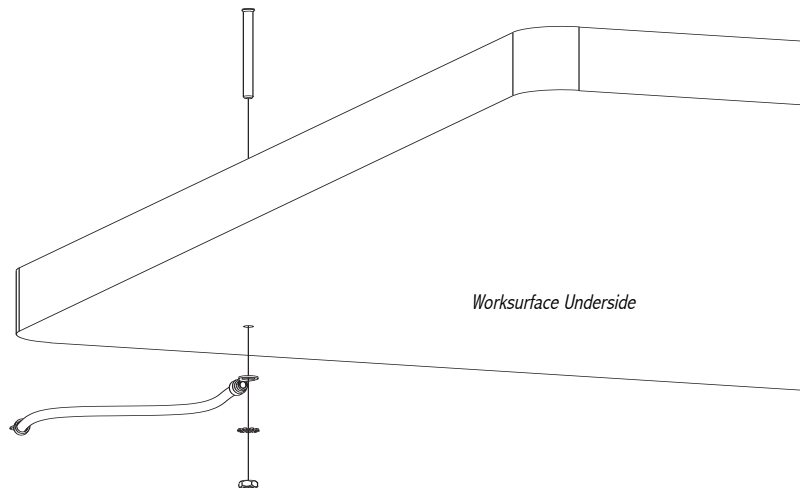

PARTS AND HARDWARE	QUANTITY
Ground Bolt	1
Ground Wire	1
Washer	1
Nut	1

1. Insert Ground Bolt through top of worksurface through pre-drilled hole.
2. Slip ground wire over bolt underneath the worksurface. Add the nut and tighten.
3. Ground other end of wire to electrical ground.

For additional information on grounding, contact your company's ESD manager or the ESD Association at 315.339.6937, [www.esda.org](http://www.esda.org).